



Catalogue

Bathroom Safety

2019

Making everyday life easier

Handicare bathroom aids by Handicare have been renowned both in the home as in healthcare facilities.

The complete range provides users with as much autonomy as possible while helping caregivers to assist safely. Handicare offers solutions that increase independence for people with disabilities and at the same time simplify the care to be given by family, caregivers and therapists.



SAFE

Our products conform to the highest standards and are suitable for users with a body weight of up to 330 (150 kg).

We are ISO 9001, ISO 13485 and NKH certified.



Practical

The design of our products is the result of extensive research and offers solutions for every situation. They are comfortable, safe, and easy to clean.



Durable

Adaptations to changing needs are possible. All materials used are resistant to moisture, heat and cold in the bathroom.



Ergonomics

Our products take into account the possibilities and limitations of users. They promote independent function and reduce the risk of falling.



Design

The round shapes are hygienic, and ensure you do not get caught. Mounting points are obscured. Available in standard and luxury versions.





TABLE OF CONTENTS BATHROOM AIDS

SHOWER SEATS 5-8

GRAB RAILS 9-16

TOILET AIDS 17-21

BATH AIDS & SHOWER STRETCHERS 22-23

COMMUNE/SHOWER CHAIRS & TROLLEYS . 25-29

 Combi shower and toilet chairs 30

USEFUL INFORMATION

 Mounting advice 24

 Technical information. 31

GENERAL

For more information on any of our products or to order please call 1-888-637-8155 or email to: sales.us@handicare.com.

Guaranteed quality

Handicare bathroom solutions conform to the highest standards and comply to the requirements of NEN-EN12182 and to the directive medical devices 93/42/EEG. We are ISO 9001, ISO 13485 and NKH certified (NKH = National Quality Mark for bathroom aids).



Colors

Handicare bathroom solutions for wall mounting are supplied standard in white, RAL 9010. Many products are also available in polished stainless steel.

Handicare introduces a range in the new color anthracite, RAL 7021. This color matches the newest trends in modern luxury bathrooms. The new color anthracite replaces the color black.



Ral 9010
white



Ral 7021
anthracite



polished ss with
white details



polished ss with
anthracite details

Materials

The products are made of:

- coated steel
- glass fibre reinforced nylon
- coated stainless steel 304 (recommended for use in institutions)
- polished stainless steel 304 (recommended for use in institutions)
- polished stainless steel 316 (recom. for use in swimming pools)
- HT-cover = Hygiene & Transfer: coated woven polyester textile

Because of the necessary electrical isolation, products for wall mounting or floor mounting, which are not designed with plastic flanges or wall plates, will be delivered with an isolation set including heavy duty washers and caps.

New Combi shower and toilet chairs

Our range of mobile bathroom products has been updated. The Combi line offers a modular system with ample possibilities for individual adjustments.

Fixing materials

Bathroom products will be delivered without mounting hardware, except for bathroom accessories. A secure installation will depend on the type of wall. Working with plasterboard, pressed fibreboard or chip board, it is necessary to reinforce the wall with for instance waterproof plywood. The type of wall will also determine the type of wall plugs or screws to be used. Please read page 34 for all mounting advice.

Handicare has taken the utmost care in compiling this catalog. Product listing, availability and prices can alter at a later date.

Handicare accepts no responsibility for any damage arising from the use of this information. Handicare is not liable for modified products.



10888 Metro Court
St. Louis, MO 63043
866-891-6502
handicareusa.com

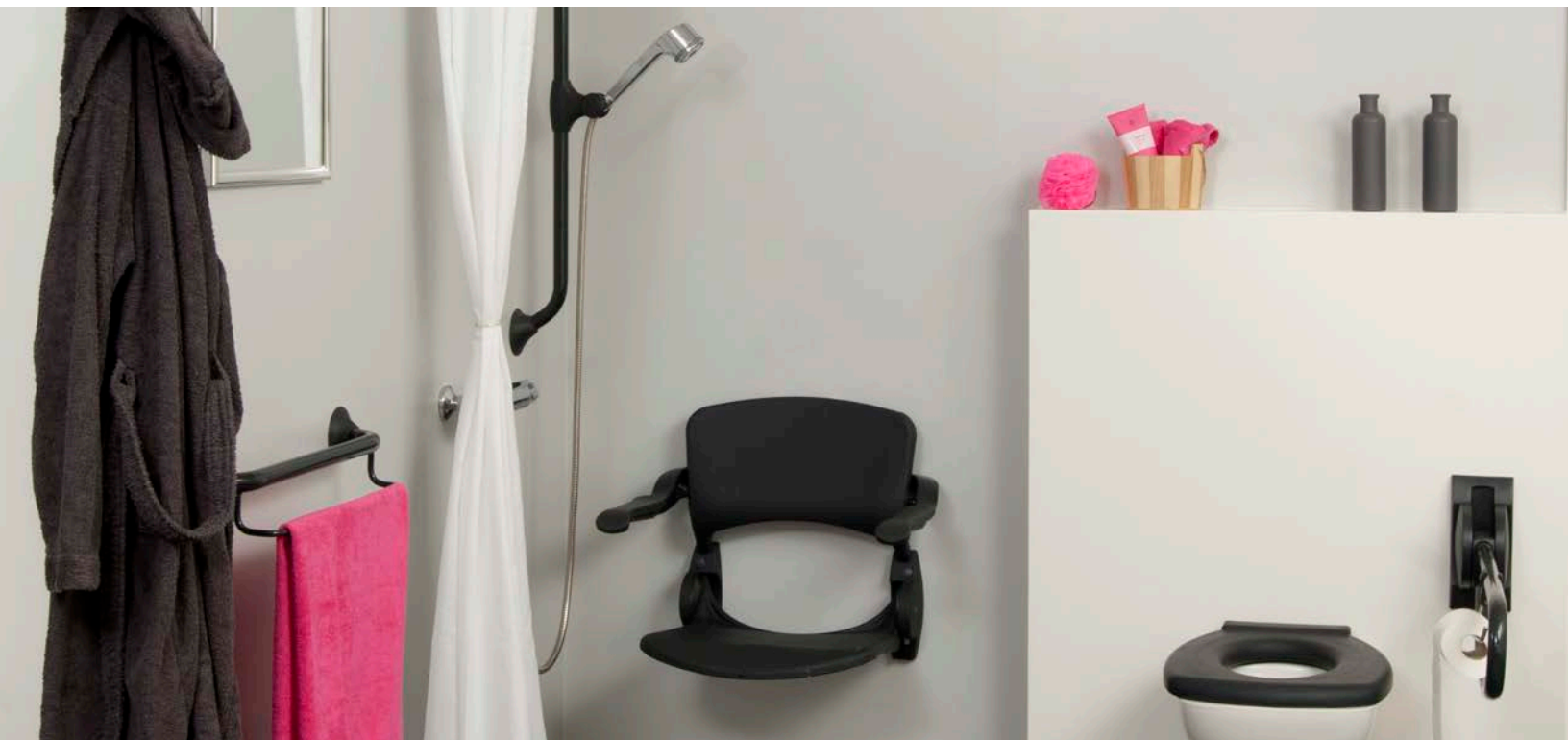

Shower seats

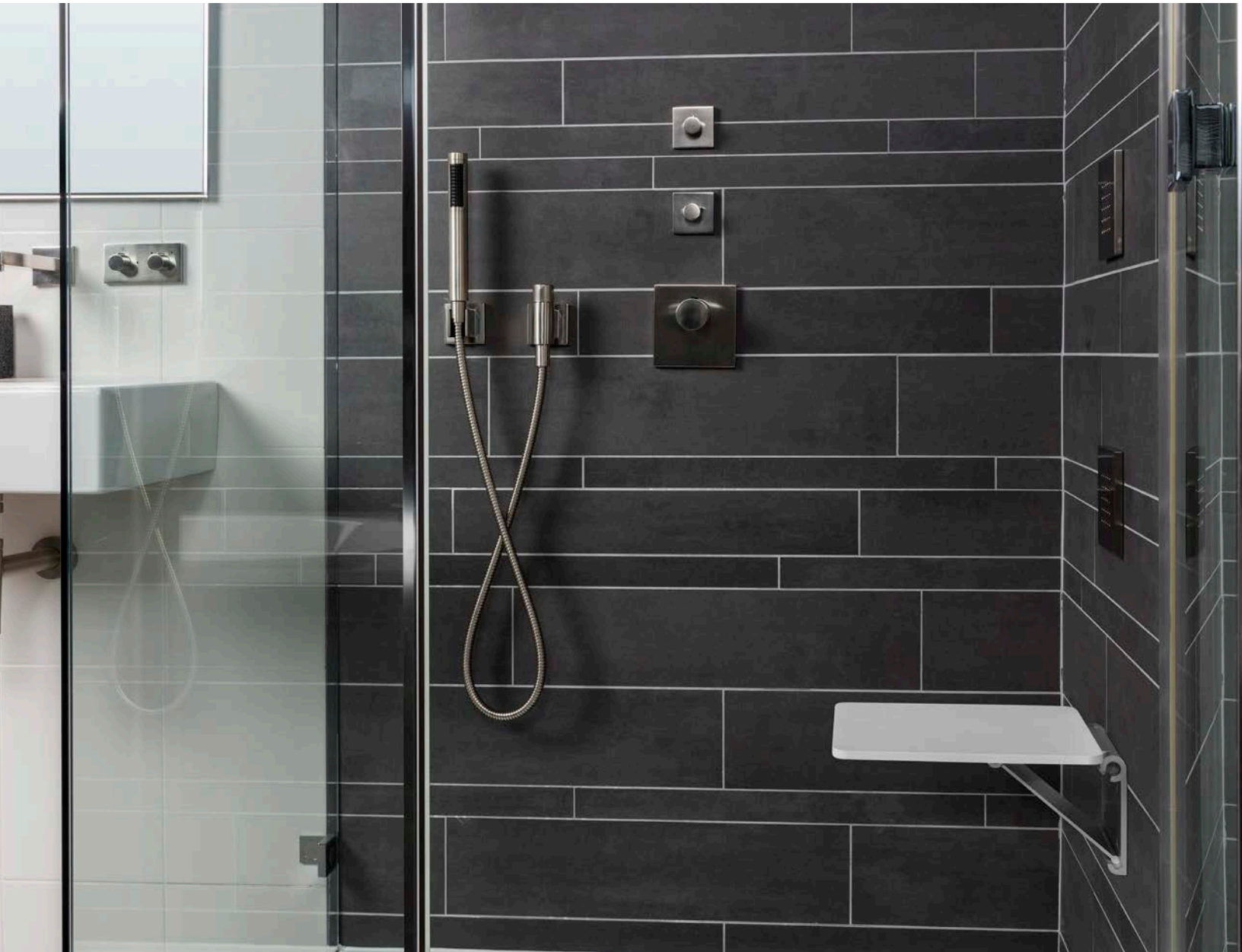

Hassle-free daily care

When showering, standing can become difficult. Handicare's shower seat offers the ideal solution. Affixed to the wall, the design is optimized for showering in a sitting position. After use, it can be folded up and out of the way. The width of the seat is tailored to the hip width of a typical user. Our shower seats have a water and dirt repellent coating on both the seat and backrest. This slows down absorption of substances such as urine and disinfectants and makes the seat easier to clean. Suitable for users with a body weight up to 330 lbs (150 kg).

Shower seats

Compact shower seat

- antibacterial Corian seat, hinged, wall-plate anodized aluminium
- seat width 10.4 in (265 mm)
- seat depth 12.8 in (326 mm)
- suitable for user weight up to 440 lbs (1050 kg)
- including drilling template
- only available in the EU

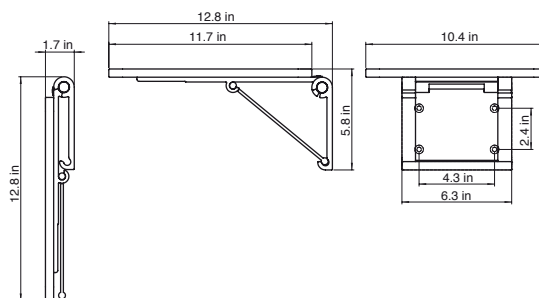

RAL 9010

Article nr.	Description
LI2201.2013-02	Compact shower seat, white

Ergonomic shower seat with backrest and armrests

- independent swivel armrests, ergonomic shape
- wall fixing set available (LI2805.000)

⚠ Floor support set LI 2214.201 recommended with a body weight > 220 lbs (100 kg) dependant on the wall structure.

Please see page 52 for information about weight limits.

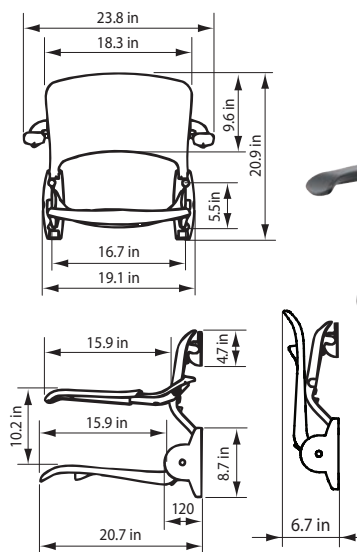

RAL 9010 RAL 7021

Article nr.	Description
LI2203.2006-02	Ergonomic shower seat with backrest and armrests, white
LI2203.2006-11	Ergonomic shower seat with backrest and armrests, anthracite
LI2805.0000-00	Wall mounting set LI2202 & LI2203

! Ergonomic shower seats are supplied including back hook and protective caps. Wall mounting sets for walls with ample strength available separately.

Height adjustment system

- can be used for shower seat without backrest LI2201.200, LI2201.001 & LI2221.021
- smooth adjustment to required seat height
- also allows mounting of shower seat at a later stage
- height adjustment 5.9 in (150 mm)
- including drilling template
- set adjustable clamp levers available (LI2815.001)

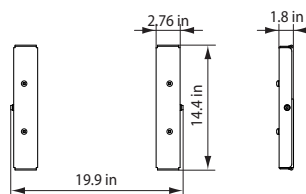

RAL 9010

Article nr.	Description
LI2215.1014-02	Height adjustment system for seat without backrest, ss/white

Shower seats

Height adjustment system

- can be used for shower seats with backrest LI2202.200, LI2203.200, LI2203.001 & LI2223.021
- smooth adjustment to required seat height
- also allows mounting of shower seat at a later stage
- height adjustment 5.9 in (150 mm)
- including drilling template
- set adjustable clamp levers available (LI2815.002)

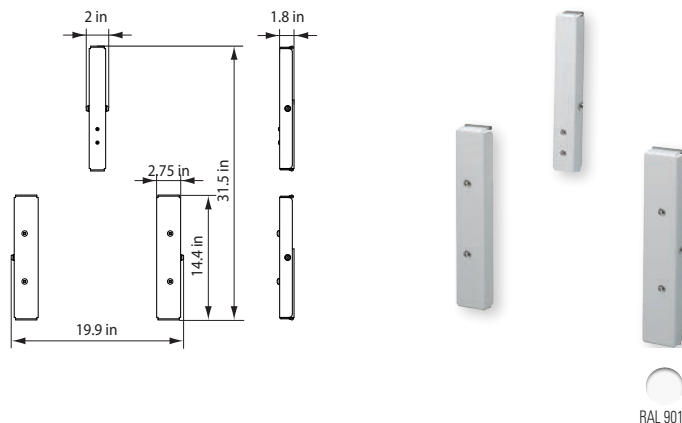

Article nr.	Description
LI2215.1024-02	Height adjustment system for seat with backrest, ss/white

Set adjustable clamp levers

LI2815.001

- For height adjustment system LI2215.001
- 2 items, black plastic

LI2815.002

- For height adjustment system LI2215.002
- 4 items, black plastic



Article nr.	Description
LI2815.0010-00	Set 2 adjustable clamp levers for use with LI2215.101
LI2815.0020-00	Set 4 adjustable clamp levers for use with LI2215.102

Set backing plates

- for fixing Linido shower seat from rear of wall
- comes with nuts M8 welded on the plate and threaded studs, washers and nuts
- supplied with backing plate for shower seats with backrests
- backing plate visible at back side of the wall
- only in white

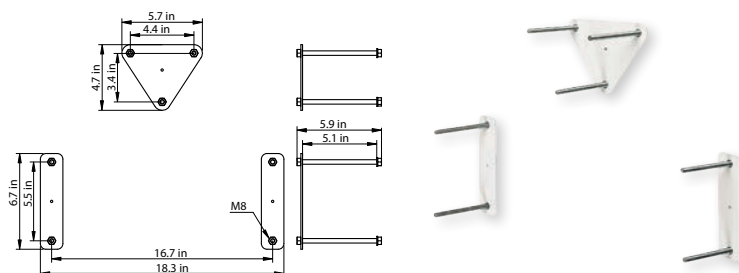

Article nr.	Description
LI0122.5084-02	Set backing plates for shower seats, ss/white

Mounting set for shower seats LI2201.200/LI2202.200/LI2203.200

- replacement set
- for covering the fixing holes and installing the backrest to a wall
- supplied as standard with our shower seats LI2202.200 / LI2203.200
- backrest hook clamp is white

Article nr.	Description
LI2801.0000-02	Mounting set for shower seats 2201 white
LI2801.0000-11	Mounting set for shower seats 2201 anthracite
LI2803.0000-02	Mounting set for shower seats 2202/2203 white
LI2803.0000-11	Mounting set for shower seats 2202/2003 anthracite

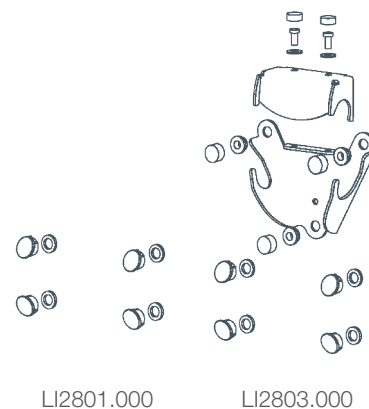

Shower seats

Wall mounting kits for shower seats

LI2806.000 for mounting Linido shower seat LI2201.200

- consisting of:
- Fischer UX 10 plugs, 4 pieces;
 - lag screw, 8 x 90 mm SS A2, 4 pieces;
 - washer M8 DIN 125, stainless A2, 4 pieces.

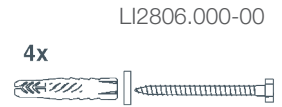

LI2805.000 for mounting Linido shower seats LI2202.200 en LI2203.200

- consisting of:
- Fischer UX 10 plugs, 7 pieces;
 - lag screw, 4 pieces 8 x 90 mm stainless A2 en 3 pieces 8 x 70 mm stainless A2
 - washer M8 DIN 125, stainless A2, 7 pieces.

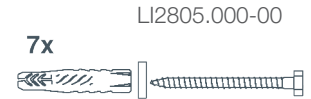

Article nr.	Description
LI2806.0000-00	Wall mounting kit LI2201 & LI2601/03.
LI2805.0000-00	Wall mounting kit LI2202 & LI2203

Floor support installation set

- replacement set
- for mounting a floor support
- supplied as standard with floor support LI2214.201
- standard available in white

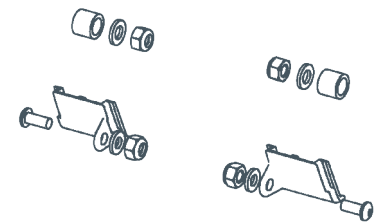

Article nr.	Description
LI2804.0000-02	Installation set for floor support LI2214.201, white

Grab rails

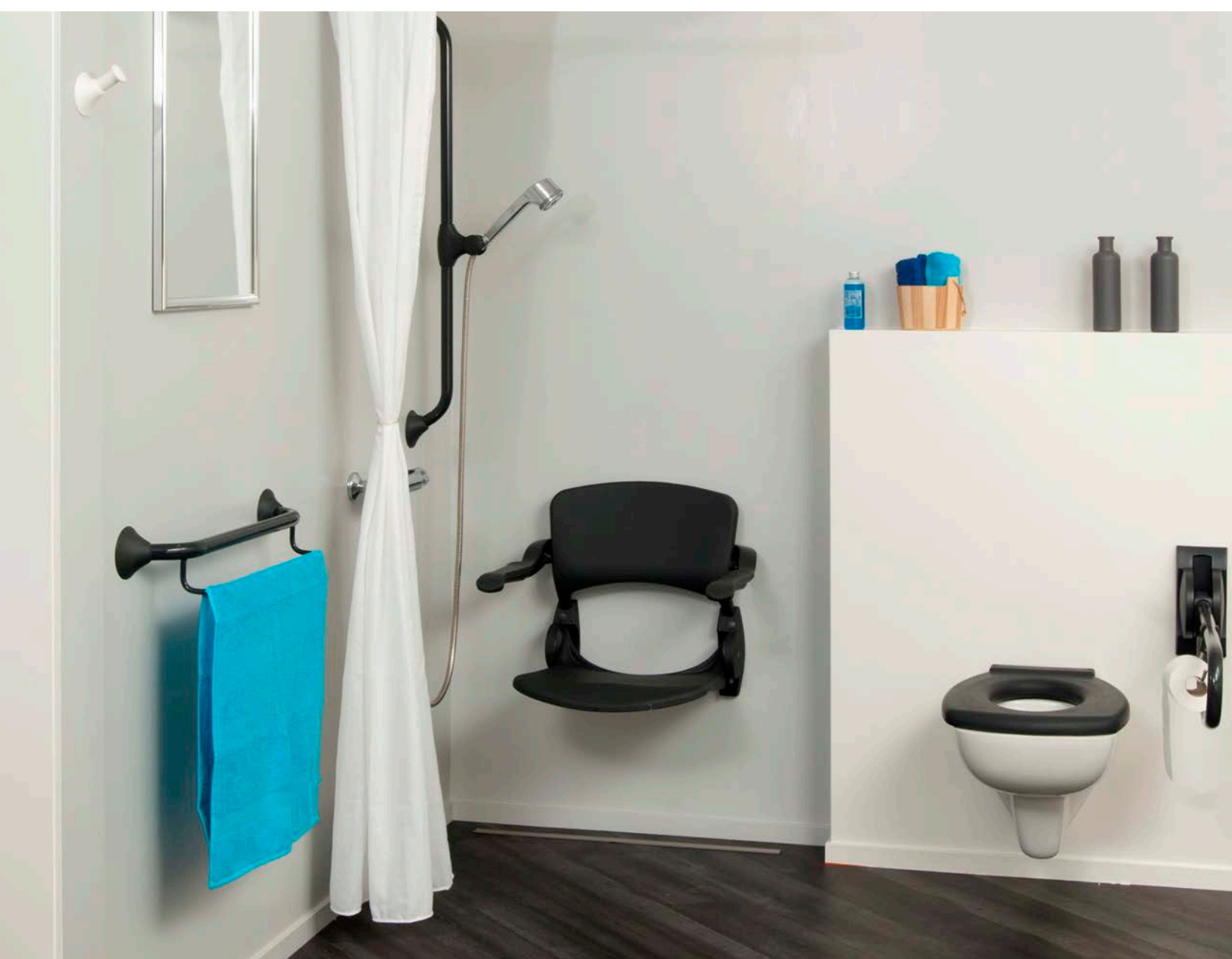

Real support in your bathroom

Handicare grab bars offer practical support that can be mounted anywhere: in the shower, or adjacent to the toilet.

The bar's diameter was specially designed to fit any hand size while providing a safe grip. The 60° angle, instead of 90°, ensures that the hand of the user remains in a natural position, which reduces the risk of falling.

Grab rails

Ergogrip

Ergogrip grab rails are suitable for users with a body weight of up to 330 lbs (150 kg). They are made of steel or stainless steel tube and have a plastic flange with a plastic cover. As the tube is bent to 60° instead of the traditional 90°, hand and wrist retain a natural position while holding the Ergogrip. In combination with the flange the Ergogrip has a smooth form which offers a firm grip.

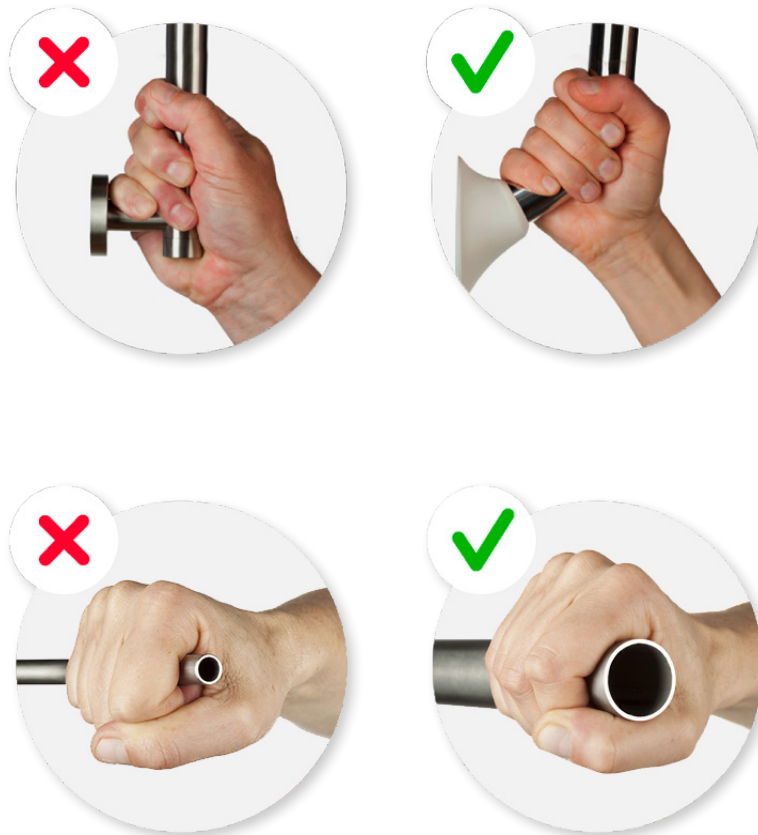

Thanks to the proper combination of shape and diameter of the tube, the user of the grab rail can achieve an optimal grip. Based on scientific data, Handicare has designed a grab rail that meets the requirements set by users of the product in terms of shape, tube diameter, bending angle and wall distance.

Grab rails

Ergogrip straight grab rails

	Length = A	B	C
LI2611.030	11.8 in	12.5 in	16 in
LI2611.040	15.75 in	16.4 in	19.9 in
LI2611.050	19.7 in	20.4 in	23.8 in
LI2611.060	23.6 in	24.3 in	27.75 in
LI2611.070	27.5 in	28.2 in	31.7 in
LI2611.080	31.5 in	32.2 in	35.6 in
LI2611.090	35.4 in	36.1 in	39.6 in
LI2611.100	39.4 in	40 in	43.5 in
LI2611.120	47.2 in	48 in	51.4 in
LI2611.140	55.1 in	55.8 in	59.25 in

- mounting set available (LI2807.000), see page 20
- combine with backing plate LI0126.503 (page 20) when in doubt about strength of wall

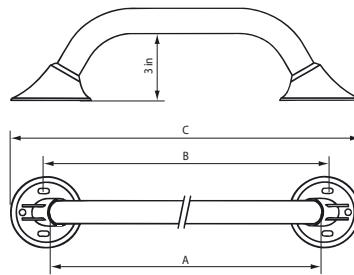

length A is the grip size

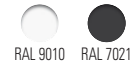
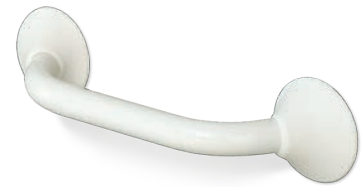

Article nr.	Ergogrip 300, length 11.8 in (300 mm)
LI2611.0301-02	Ergogrip grab rail white
LI2611.0301-11	Ergogrip grab rail anthracite
LI2611.0304-02	Ergogrip grab rail ss/white
LI2611.0302-00	Ergogrip grab rail polished ss, details white
LI2611.0302-11	Ergogrip grab rail polished ss, details anthracite
	Ergogrip 400, length 15.75 in (400 mm)
LI2611.0401-02	Ergogrip grab rail white
LI2611.0401-11	Ergogrip grab rail anthracite
LI2611.0404-02	Ergogrip grab rail ss/white
LI2611.0402-00	Ergogrip grab rail polished ss, details white
LI2611.0402-11	Ergogrip grab rail polished ss, details anthracite
	Ergogrip 500, length
LI2611.0501-02	Ergogrip grab rail white
LI2611.0501-11	Ergogrip grab rail anthracite
LI2611.0504-02	Ergogrip grab rail ss/white
LI2611.0502-00	Ergogrip grab rail polished ss, details white
LI2611.0502-11	Ergogrip grab rail polished ss, details anthracite
	Ergogrip 600, length
LI2611.0601-02	Ergogrip grab rail white
LI2611.0601-11	Ergogrip grab rail anthracite
LI2611.0604-02	Ergogrip grab rail ss/white
LI2611.0602-00	Ergogrip grab rail polished ss, details white
LI2611.0602-11	Ergogrip grab rail polished ss, details anthracite
	Ergogrip 700, length 27.5 in (700 mm)
LI2611.0701-02	Ergogrip grab rail white
LI2611.0701-11	Ergogrip grab rail anthracite
LI2611.0704-02	Ergogrip grab rail ss/white
LI2611.0702-00	Ergogrip grab rail polished ss, details white
LI2611.0702-11	Ergogrip grab rail polished ss, details anthracite

	Ergogrip 800, length 31.5 in (800mm)
LI2611.0801-02	Ergogrip grab rail white
LI2611.0801-11	Ergogrip grab rail anthracite
LI2611.0804-02	Ergogrip grab rail ss/white
LI2611.0802-00	Ergogrip grab rail polished ss, details white
LI2611.0802-11	Ergogrip grab rail polished ss, details anthracite
	Ergogrip 900, length 35.4 in (900mm)
LI2611.0901-02	Ergogrip grab rail white
LI2611.0901-11	Ergogrip grab rail anthracite
LI2611.0904-02	Ergogrip grab rail ss/white
LI2611.0902-00	Ergogrip grab rail polished ss, details white
LI2611.0902-11	Ergogrip grab rail polished ss, details anthracite
	Ergogrip 1000, length 39.4 in (1000 mm)
LI2611.1001-02	Ergogrip grab rail white
LI2611.1001-11	Ergogrip grab rail anthracite
LI2611.1004-02	Ergogrip grab rail ss/white
LI2611.1002-00	Ergogrip grab rail polished ss, details white
LI2611.1002-11	Ergogrip grab rail polished ss, details anthracite
	Ergogrip 1200, length 47.2 in (1200 mm)
LI2611.1201-02	Ergogrip grab rail white
LI2611.1201-11	Ergogrip grab rail anthracite
LI2611.1204-02	Ergogrip grab rail ss/white
LI2611.1202-00	Ergogrip grab rail polished ss, details white
LI2611.1202-11	Ergogrip grab rail 1 polished ss, details anthracite
	Ergogrip 1400, length 55.1 in (1400 mm)
LI2611.1401-02	Ergogrip grab rail white
LI2611.1401-11	Ergogrip grab rail anthracite
LI2611.1404-02	Ergogrip grab rail ss/white
LI2611.1402-00	Ergogrip grab rail polished ss, details white
LI2611.1402-11	Ergogrip grab rail polished ss, details anthracite

Grab rails

Ergogrip 200 grab rails

Length = A B C
LI2611.020 7 in 7.875 in 10.8 in

- mounting set available (LI2807.000, see page 16)
- combine with backing plate LI0126.503 (page 16) when in doubt about strength of wall

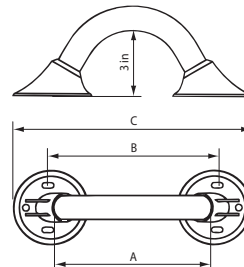

length A is the grip size



RAL 9010 RAL 7021

Article nr.	Description
LI2611.0201-02	Grab rail white
LI2611.0201-11	Grab rail anthracite
LI2611.0204-02	Grab rail ss/white
LI2611.0202-00	Grab rail polished ss, details white
LI2611.0202-11	Grab rail polished ss, details anthracite



Horizontal angled grab rail

Ergogrip corner S

- for two walls
- use mounting set LI2807.000 (page 20) (order 2 sets because of extra flange)
- combine with backing plate LI0126.503 (page 20) when in doubt about strength of wall

Ideal to combine with our vertical combination grab rail LI2611.018 or LI2611.019 to form a sturdy shower rail, and shower holder LI2630.200 (page 19).

Note: order vertical combination grab rail and shower holder separately

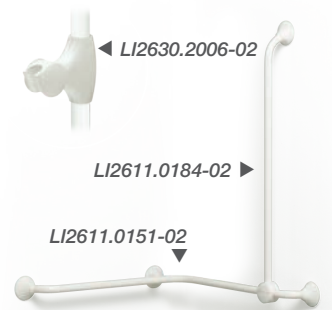
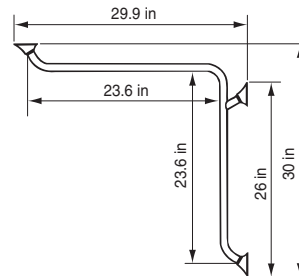

RAL 9010 RAL 7021

Article nr.	Description
LI2611.0151-02	Horizontal angled grab rail white
LI2611.0151-11	Horizontal angled grab rail anthracite
LI2611.0154-02	Horizontal angled grab rail ss/white
LI2611.0152-00	Horizontal angled grab rail polished ss, details white
LI2611.0152-11	Horizontal angled grab rail polished ss, details anthracite

Angled grab rail for two walls

Ergogrip corner L

- for two walls
- use mounting set LI2807.000 (page 20) (order 2 sets because of extra flange)
- combine with backing plate LI0126.503 (page 20) when in doubt about strength of wall

Ideal to combine with our vertical combination grab rail LI2611.018 or LI2611.019 to form a sturdy shower rail, and shower holder LI2630.200 (page 19).

Note: order vertical combination grab rail and shower holder separately

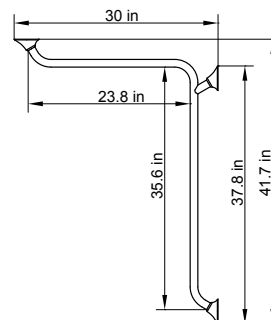

RAL 9010 RAL 7021

Article nr.	Description
LI2611.0251-02	Horizontal angled grab rail white
LI2611.0251-11	Horizontal angled grab rail anthracite
LI2611.0254-02	Horizontal angled grab rail ss/white
LI2611.0252-00	Horizontal angled grab rail polished ss, details white
LI2611.0252-11	Horizontal angled grab rail polished ss, details anthracite

Grab rails

Vertical combination grab rail

Ergogrip corner combination grab rail

- combine with any grab rails Ergogrip, 30 cm or larger, to determine your own ideal set-up.
- combine with backing plate LI0126.503 (page 20) when in doubt about strength of wall
- combined with a shower holder (LI2630.200) this combination grab rails also makes a sturdy shower rail!

Note: order shower holder (page 19) separately

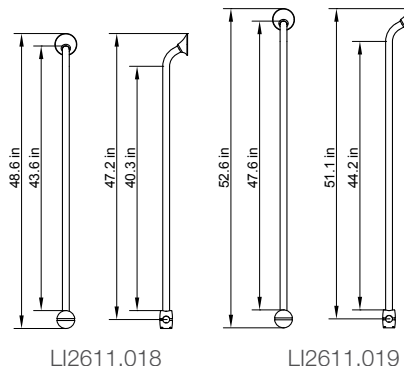

LI2611.018

LI2611.019



▲ LI2630.2006-02



Article nr.	Description
LI2611.0184-02	Vertical combination grab rail coated ss, white
LI2611.0184-11	Vertical combination grab rail coated ss, anthracite
LI2611.0182-00	Vertical combination grab rail polished ss, details white
LI2611.0182-11	Vertical combination grab rail polished ss, details anthracite

Article nr.	Description
LI2611.0194-02	Vertical combination grab rail coated ss, white
LI2611.0194-11	Vertical combination grab rail coated ss, anthracite
LI2611.0192-00	Vertical combination grab rail polished ss, details white
LI2611.0192-11	Vertical combination grab rail polished ss, details anthracite

Angled grab rail 90 degrees

Ergogrip 90 left (A)

Ergogrip 90 right (B)

- recommended for mounting in bath and shower situations
- combined with a shower holder (LI2630.200) this grab rail also makes a sturdy shower rail!
- mounting set LI2807.000 (page 20) can be used (order 2x because of extra flange)
- combine with backing plate LI0126.503 (page 20) when in doubt about strength of wall

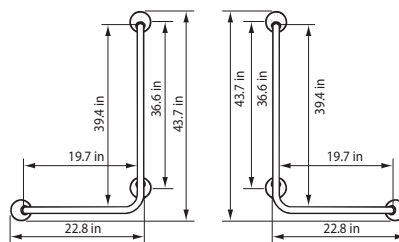

LI2611.003

LI2611.004

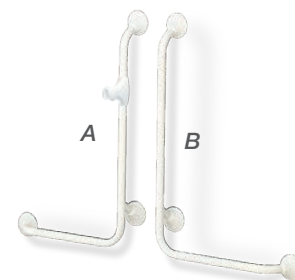

Article nr.	Description
LI2611.0031-02	Angled grab rails 90° white
LI2611.0031-11	Angled grab rails 90° anthracite
LI2611.0034-02	Angled grab rails 90° ss/white
LI2611.0032-00	Angled grab rails 90° polished ss, details white
LI2611.0032-11	Angled grab rails 90° polished ss, details anthracite

Article nr.	Description
LI2611.0041-02	Angled grab rails 90° white
LI2611.0041-11	Angled grab rails 90° anthracite
LI2611.0044-02	Angled grab rails 90° ss/white
LI2611.0042-00	Angled grab rails 90° polished ss, details white
LI2611.0042-11	Angled grab rails 90° polished ss, details anthracite

A: Left

B: Right

Grab rails

Angled grab rail 90 degrees

Ergogrip 90 left (A) Ergogrip 90 right (B)

- recommended for mounting in bath and shower situations
- combined with a shower holder (LI2630.200) this grab rail also makes a sturdy shower rail!
- mounting set LI2807.000 (page 20) can be used (order 2x because of extra flange)
- combine with backing plate LI0126.503 (page 20) when in doubt about strength of wall

LI2611.023

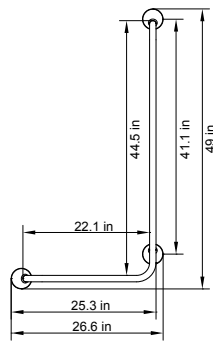

LI2611.024

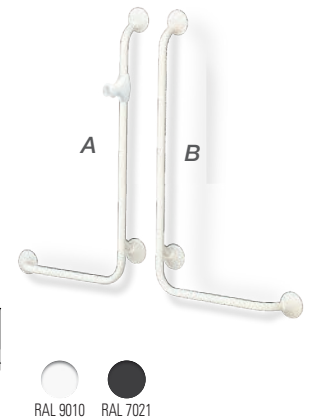
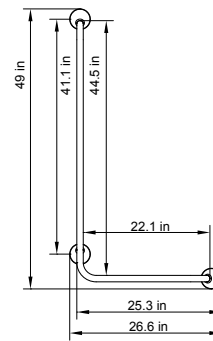

Article nr.	Description
LI2611.0231-02	Angled grab rails 90° white
LI2611.0231-11	Angled grab rails 90° anthracite
LI2611.0234-02	Angled grab rails 90° ss/white
LI2611.0232-00	Angled grab rails 90° polished ss, details white
LI2611.0232-11	Angled grab rails 90° polished ss, details anthracite

Article nr.	Description
LI2611.0241-02	Angled grab rails 90° white
LI2611.0241-11	Angled grab rails 90° anthracite
LI2611.0244-02	Angled grab rails 90° ss/white
LI2611.0242-00	Angled grab rails 90° polished ss, details white
LI2611.0242-11	Angled grab rails 90° polished ss, details anthracite

Shower head holder

- total plastic construction
- suitable for every Ergogrip grab rail from 30 cm or more; converts an Ergogrip into a safe shower rail
- can also be fitted after installation of the Ergogrip grab rail
- light and easily adjustable over the full length of Ergogrip grab rail
- ergonomic grip
- for conical shaped collar of shower tube



Article nr.	Description
LI2630.2006-02	Shower head holder white
LI2630.2006-11	Shower head holder anthracite



Angled grab rail 45 degrees

Ergogrip 45 Small (A) Ergogrip 45 Large (B)

- recommended for mounting beside toilet or bath
- mounting set LI2807.000 can be used (page 20)
- combine with backing plate LI0126.503 (page 20) when in doubt about strength of wall

LI2611.007

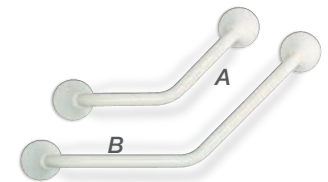
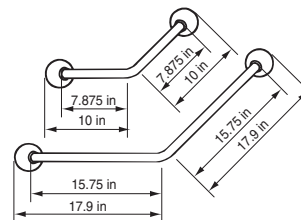

LI2611.008



Article nr.	Description
LI2611.0071-02	Angled grab rail 45° white
LI2611.0071-11	Angled grab rail 45° anthracite
LI2611.0074-02	Angled grab rail 45° ss/white
LI2611.0072-00	Angled grab rail 45° polished ss, details white
LI2611.0072-11	Angled grab rail 45° polished ss, details anthracite

Article nr.	Description
LI2611.0081-02	Angled grab rail 45° white
LI2611.0081-11	Angled grab rail 45° anthracite
LI2611.0084-02	Angled grab rail 45° ss/white
LI2611.0082-00	Angled grab rail 45° polished ss, details white
LI2611.0082-11	Angled grab rail 45° polished ss, details anthracite

Grab rails

Towel rail

LI2637.001 (300 mm) Towel rail Small

LI2637.002 (600 mm) Towel rail Large

- combination of towel rail and grab rail
- top tube can be used as grab rail

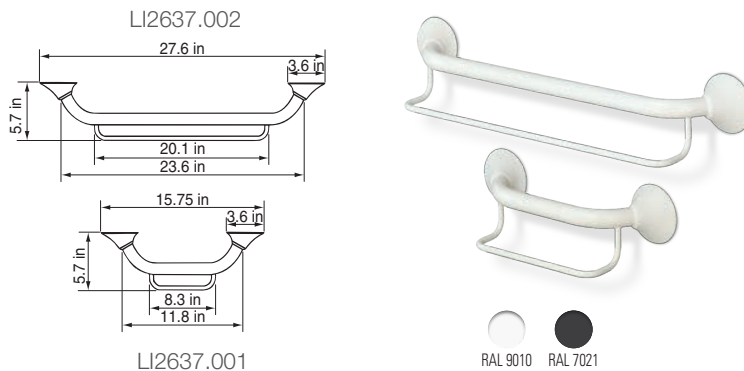

Article nr.	Description
LI2637.0011-02	Towel rail white
LI2637.0011-11	Towel rail anthracite
LI2637.0014-02	Towel rail ss/white
LI2637.0012-00	Towel rail polished ss, details white
LI2637.0012-11	Towel rail polished ss, details anthracite

Article nr.	Description
LI2637.0021-02	Handdoekenrek wit
LI2637.0021-11	Handdoekenrek antraciet
LI2637.0024-02	Handdoekenrek RVS/wit
LI2637.0022-00	Handdoekenrek RVS gepolijst, details wit
LI2637.0022-11	Handdoekenrek RVS gepolijst, details antraciet

Backing plate round

- for fixing Ergogrip from rear of wall
- comes complete with nuts M6 welded on the plate and threaded studs, washers and nuts
- backing plate visible at back side of the wall
- only in white
- not suitable for system walls

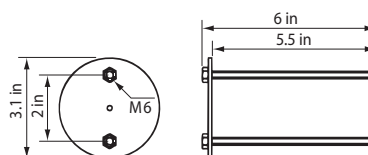

Article nr.	Description
LI0126.5034-02	CBacking plate grsb rails ss/white

Wall mounting set

- for mounting of all Linido grab rails
- consisting of:
 - Fischer UX 8 plugs, 4 pieces;
 - lag screw, 6 x 60mm ss A2, 4 pieces
 - washer M8 DIN 125, ss A2, 4 pieces



Article nr.	Description
LI2807.000	Wall mounting set for grab rails

Stair newel grab rails

Stair newel grab rail A

Stair newel grab rail B

- for two walls (inner corner)

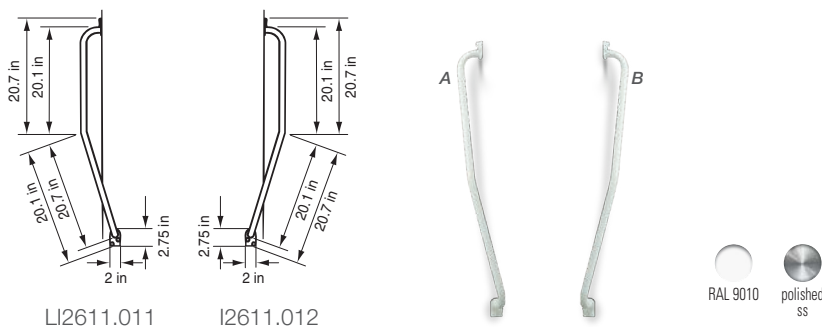

Article nr.	Description
LI2611.0111-02	Grab rail for stair newel A (newel on RH-side), white
LI2611.0114-02	Grab rail for stair newel A (newel on RH-side), ss/white
LI2611.0112-00	Grab rail for stair newel A (newel on RH-side), polished ss

Article nr.	Description
LI2611.0121-02	Grab rail for stair newel B (newel on LH-side), white
LI2611.0124-02	Grab rail for stair newel B (newel on LH-side), ss/white
LI2611.0122-00	Grab rail for stair newel B (newel on LH-side), polished ss

Grab rails

Door frame grab rails

	Length =	A	B	C	D
LI2619.030		11.8 in	11 in	9.4 in	8.5 in
LI2619.045		17.7 in	17 in	15.4 in	14.4 in
LI2619.060		23.6 in	22.8 in	21.25 in	20.3 in

- the small flange makes this extremely suitable for mounting on doorframes
- diameter tube 0.875 in (22 mm)
- only available in these measurements
- only in white

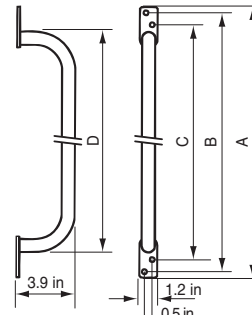

RAL 9010

Article nr.	Description
LI2619.0301-02	Door frame grab rails 11.8 in (300 mm) white
LI2619.0451-02	Door frame grab rails 17.7 in (450 mm) white
LI2619.0601-02	Door frame grab rails 23.6 in (600 mm) white

Shower curtain rail

Shower curtain rail

- for corner shower
- without curtain and rings

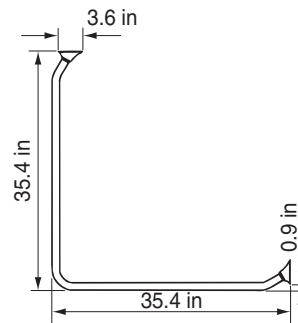

RAL 9010

Article nr.	Description
LI2641.0001-02	Shower curtain rail 90° white
LI2641.0002-00	Shower curtain rail 90° polished ss, details white

Ceiling mounting set for shower curtain rail

- can be shortened to the desired height

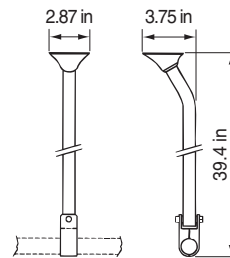

RAL 9010

Article nr.	Description
LI2641.1003-02	Ceiling mounting kit white

Toilet aids



Extra support & comfort when using the toilet

Arm support offers the user firm support when sitting down on the toilet and getting up again. It is also suitable to lean against when undressing or dressing. The arm support can be folded up after which it automatically locks. When folded up, the bracket can also give support when using the toilet standing up, or when cleaning the toilet. The lateral load is 220 lbs (100 kg) and a horizontal load is 330 lbs (150 kg).

Fixed & hinged arm supports

Hinged arm supports

LI2603.350 length 20.9 in (530 mm)

LI2603.360 length 23.6 in (600 mm)

LI2603.370 length 27.5 in (700 mm)

LI2603.380 length 31.5 in (800 mm)

LI2603.390 length 35.4 in (900 mm)

- offers support in both horizontal and vertical position
- locks automatically in the upright position
can also be used as addition to a shower seat when there is not enough space for shower seat with backrest and armrests or when a higher load than 220 lbs (100 kg.) for the armrest is desired
- plastic wall plate with tube of coated steel, coated stainless steel or polished stainless steel
- fixing mount available (LI2806.000, page 12)
- also available with diameter 32 mm

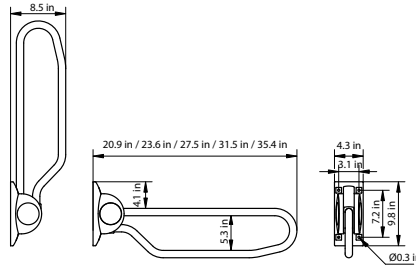

Article nr.	Hinged arm support, length 20.9 in (530 mm)
LI2603.3501-02	Hinged arm support white
LI2603.3501-11	Hinged arm support anthracite
LI2603.3504-02	Hinged arm support coated ss/white
LI2603.3502-02	Hinged arm support polished ss, details white
LI2603.3502-11	Hinged arm support polished ss, details anthracite
Hinged arm support, length 23.6 in (600 mm)	
LI2603.3601-02	Hinged arm support white
LI2603.3601-11	Hinged arm support anthracite
LI2603.3604-02	Hinged arm support coated ss/white
LI2603.3602-02	Hinged arm support polished ss, details white
LI2603.3602-11	Hinged arm support polished ss, details anthracite
Hinged arm support, length 27.5 in (700 mm)	
LI2603.3701-02	Hinged arm support white
LI2603.3701-11	Hinged arm support anthracite
LI2603.3704-02	Hinged arm support coated ss/white
LI2603.3702-02	Hinged arm support polished ss, details white
LI2603.3702-11	Hinged arm support polished ss, details anthracite

Hinged arm support, length 31.5 in (800 mm)	
LI2603.3801-02	Hinged arm support white
LI2603.3801-11	Hinged arm support anthracite
LI2603.3804-02	Hinged arm support coated ss/white
LI2603.3802-02	Hinged arm support polished ss, details white
LI2603.3802-11	Hinged arm support polished ss, details anthracite
Hinged arm support, length 35.4 in (900 mm)	
LI2603.3901-02	Hinged arm support white
LI2603.3901-11	Hinged arm support anthracite
LI2603.3904-02	Hinged arm support coated ss/white
LI2603.3902-02	Hinged arm support polished ss, details white
LI2603.3902-11	Hinged arm support polished ss, details anthracite
Wall mounting set	
LI2806.000-00	Wall mounting set for LI2201 LI2601/03

LI2806.000-00 4 pcs per set

Floor console for hinged arm support

- recommended when wall mounting of the hinged arm support is not possible or desirable
- including backing plate and aluminum clamps for mounting of hinged arm support
- once mounted on the floor console the hinged arm support can be readjusted

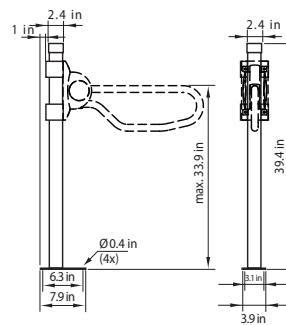

Article nr.	Description
LI2608.0001-02	Floor console + clamps white
LI2608.0001-11	Floor console + clamps anthracite
LI2608.0004-02	Floor console + clamps ss/white
LI2608.0002-02	Floor console + clamps polished ss

Fixed & hinged arm supports

Floor support set for hinged arm support

- recommended if there is any doubt about the strength of the wall
- consists of adjustable floor support, clamps and distance stay
- smooth height adjustment for hinged arm support with height from floor to top of support from 27.5 in - 33.5 in (700 mm to 850 mm)
- can also be fitted after installation of the hinged arm support (LI2603.3xx)
- not applicable on LI2603.350

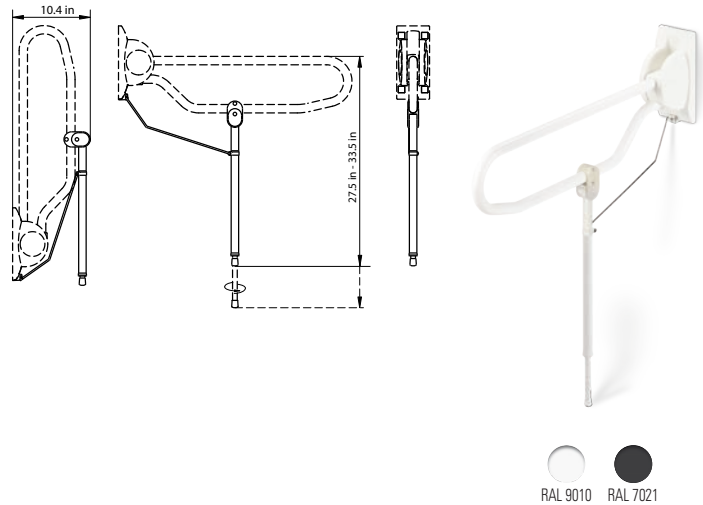

Article nr.	Description
LI2614.3001-02	Floor support set for hinged arm support white
LI2614.3001-11	Floor support set for hinged arm support anthracite
LI2614.3004-02	Floor support set for hinged arm support ss/white
LI2614.3002-00	Floor support set for hinged arm support polished ss

Height adjustment system for hinged arm support

- can be used for hinged arm supports LI2603.3xx
- smooth height adjustment to required height of support
- allows mounting of hinged arm at a later stage
- range in adjustment 5.9 in (150 mm)
- set adjustable clamp levers available (LI2815.001)

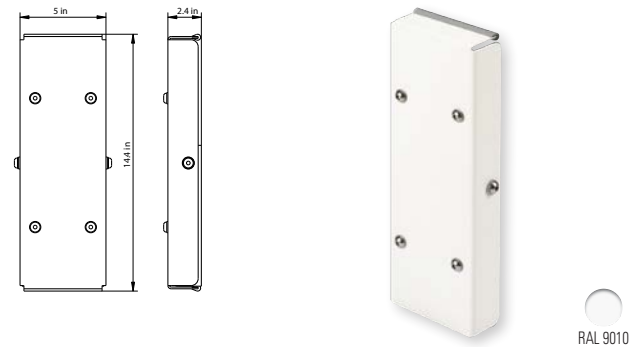

Article nr.	Description
LI2615.3004-02	Height adjustment system for 2603.3xx ss/white

Set adjustable clamp levers

- To be used with height adjustment system LI2615.3004-02. 2 pieces, black plastic.



Article nr.	Description
LI2815.0010-00	Set of 2 adjustable clamp levers for LI2615.3004-02

Pay attention when mounting



TIP

- Make sure the arm supports are mounted symmetrically to load the body of the user evenly.
- If you place only one toilet bracket, find out when the user needs support: is this specifically when sitting down or when getting up again, has the user a weaker arm, or has the user a diminished use of an arm?
- Make sure the arm support is protruding 5.9 in- 7.9 in (150 - 200 mm) in front of the toilet. This causes the arm of the user to stay in a natural position when sitting down and getting up again.
- Choose an arm support in a contrasting color when the user has impaired vision.

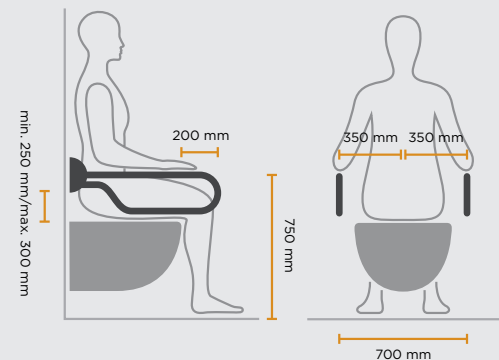

Fixed & hinged arm supports

Backing plate rectangular

- for fixing hinged arm support from rear of wall
- comes complete with welded nuts M8 and matching threaded studs, washers and nuts
- backing plate visible at back side of the wall
- only in white
- not suitable for fixed arm supports

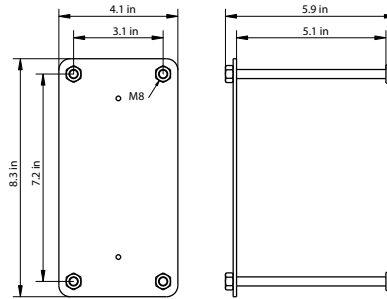

Article nr.	Description
LI0126.5014-02	Backing plate for hinged arm support ss/white

Toilet roll holder

- polished stainless steel roll holder with black plastic clamp for mounting onto Linido hinged arm support (LI2603.3xx), fixed arm support (LI2601.0xx) or Ergogrip grab rail (LI2611.xxx)
- also available for tube diameter 1.25 in (32 mm)

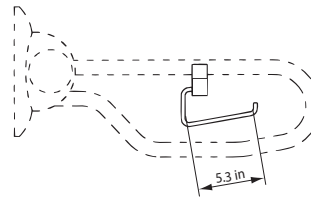

Article nr.	Description
LI2617.0002-03	Toilet roll holder with clamp, ss/black
LI2617.9002-03	Toilet roll holder with clamp, for tube Ø 1.25 in, ss/black

Toilet roll holder single-hand

- plastic toilet roll holder, which makes it possible to change, unroll and tear the toilet paper with one hand
- fits any Linido hinged arm support (LI2603.3xx), fixed arm support (LI2601.0xx) or any Ergogrip grab rail (LI2611.xxx) larger than 15.75 in (400 mm)
- only in white

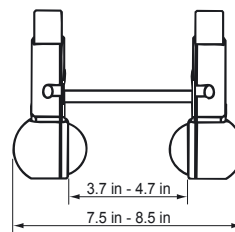

Article nr.	Description
LI2618.0006-02	Toilet roll holder for single-handed use, white

Toilet aids

Toilet raiser with lid

- increases the seat height of a toilet by 3.9 in (100 mm)
- fits most standard-size toilets
- easy to install, no tools needed
- only available in white
- max. user weight: 285 lbs (130 kg)

Article nr.	Description
10735	Toilet raiser with lid



Toilet raiser with armrests and lid

- increases the seat height of a toilet by 3.3 in (85 mm), 4.9 in (125 mm) or 6.5 in (165 mm)
- removable, independent, swivel armrests
- fits most standard-size toilets
- easy to install, no tools needed
- includes standard toilet seat and lid
- only available in white
- max. user weight: 285 lbs (130 kg)

⚠ not suitable for lateral transfers.

If desired, we recommend fitting hinged armrests (LI2603.3xx) next to the toilet.



Article nr.	Description
10659	Toilet raiser with armrests and lid

Bath aids & shower stretchers



Making everyday life easier

Our bathroom solutions help maintain the independence of the user. Shower stretchers are an excellent solution for showering in a lying position and offer the caregiver a good posture to avoid unnecessary loads. Our bath aids are easy to clean and have a high load capability.

Shower stretchers

Shower stretcher with adjustable backrest

- HT-cover* material
- hinges to the wall (folds up or folds down)
- hinged leg supports
- including wall clamp to secure stretcher when folded up against the wall
- available with adjustable backrest by means of a gas spring and with pvc water receiver and flexible drain hose
- suitable for users with a body weight up to 330 lbs (150 kg)

	A	B	C
LI2408.150	59.8 in	18.3 in	7.9 in
LI2408.170	67.7 in	24.2 in	11.8 in
LI2408.190	75.5 in	24.2 in	5.75 in

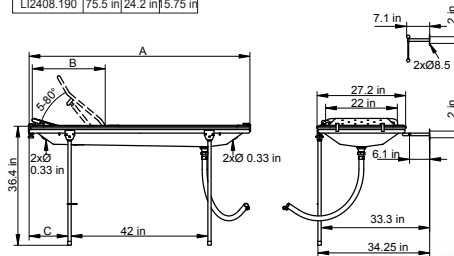

* = Hygiene & Transfer: coated woven polyester textile

Article nr.	Description	
LI2408.1904-02	Shower stretcher w. adj. backrest, coated ss white	74.8 in. (1900 mm)

Removable side fence

- suitable for all Linido shower stretchers and shower trolleys
- including plastic mounting clamps

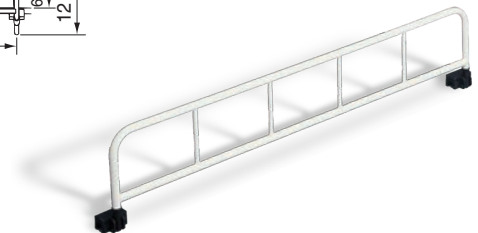
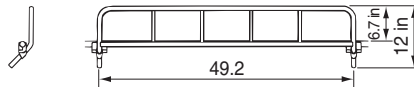

Article nr.	Description	
LI2490.1254-02	Removable side fence, coated ss white	49.2 in. (1250 mm)

Mounting advice

Product:	Shower seat: LI2203.200-series;	Shower seat: LI2201.200-series; Shower seat: LI2221.021-series; Shower seat: LI2201.001-series; Hinged arm support: LI2603.3-series; Fixed arm support: LI2601-series; Floor console: LI2608-series; Swinging support: LI2613-series; Height adjustment system: LI2215-series; Height adjustment system: LI2615-series;	Ergogrip grab rails: LI2611-series 2 flanges; Shower stretcher: LI24-series; Stair newel grab rail: LI2611.011-series; Stair newel grab rail: LI2611.012-series; Door frame grab rail: LI2619-series; Vertical combination grab rail: LI2611.018/019-series 1 flanges
Type wall	Mounting with	Mounting with	Mounting with
Solid concrete, Natural stone, Solid red brick, Sand-lime brick	Article number LI2805.0000-00 consisting of: Fischer UX 10 plugs, 7 pieces; lag screw DIN 571, 8 x 90 mm SS A2, 4 pieces; lag screw DIN 571, 8 x 70 mm SS A2, 3 pieces; washer M8 DIN 125, SS A2, 7 pieces. Always adapt length of fastening material to thickness of load-bearing part of wall construction, taking into account the layer thickness finish.	Article number LI2806.0000-00 consisting of: Fisher UX 10 plugs, 4 pieces; lag screw DIN 571, 8 x 90 mm SS A2, 4 pieces; washer M8 DIN 125, SS A2, 4 pieces. For LI2215-series two mounting sets are needed. Always adapt length of fastening material to thickness of load-bearing part of wall construction, taking into account the layer thickness finish.	Article number LI2807.0000-00 consisting of: Fisher UX 8 plugs, 4 pieces; lag screw DIN 571, 6 x 60 mm SS A2, 4 pieces; washer M8 DIN 125, SS A2, 4 pieces. For LI2611-series with 3 flanges two mounting sets are needed. Always adapt length of fastening material to thickness of load-bearing part of wall construction, taking into account the layer thickness finish.
Solid/massive aerated concrete (Ytong, Durox), Plaster block, Pumice solid brick Perforated/hollow Hollow brick (Poriso), Hollow sand-lime brick	Injection mortar + injection sleeve and, if necessary: threaded sleeve; threaded rod DIN976 M8, SS A2, 7 pieces; washer DIN125 M8, SS A2, 7 pieces; nut DIN934 M8, SS A2, 7 pieces. Possible materials to apply are: - FIS VS injection mortar; - Fischer threaded rod DIN976 M8, SS A2. Always adapt length of fastening material to thickness of load-bearing part of wall construction, taking into account the layer thickness finish.	Injection mortar + injection sleeve and, if necessary: threaded sleeve; threaded rod DIN976 M8, SS A2, 4 pieces; washer DIN 125 M8, SS A2, 4 pieces; nut DIN 934 M8, SS A2, 4 pieces. For LI2215-series 6 pieces of each are needed. Possible materials to apply are: - FIS VS injection mortar; - Fischer threaded rod DIN976 M8, SS A2. Always adapt length of fastening material to thickness of load-bearing part of wall construction, taking into account the layer thickness finish.	Injection mortar + injection sleeve and, if necessary: threaded sleeve; threaded rod DIN976 M6, SS A2, 4 pieces; washer DIN 125 M6, SS A2, 4 pieces; nut DIN 934, SS A2, 4 pieces. For LI2611-series with 3 flanges 6 pieces of each are needed. Possible materials to apply are: - FIS VS injection mortar; - Fischer threaded rod DIN976 M6, SS A2. Determine length of threaded rod in accordance with mounting set LI2807.0000-00. Always adapt length of fastening material to thickness of load-bearing part of wall construction, taking into account the layer thickness finish.
Plaster board, Squeezed fibreboard, Chipboard	Reinforce the wall with at least 32 mm marine plywood, consult producer of partitioning system on the support structure. lag screw DIN 571, 8 mm, SS A2, 4 pieces; lag screw DIN 571, 8 mm, SS A2, 3 pieces; washer DIN 125 M8, SS A2, 7 pieces.	Reinforce the wall with at least 32 mm marine plywood, consult producer of partitioning system on the support structure. lag screw DIN 571, 8 mm, SS A2, 4 pieces; washer DIN 125 M8, SS A2, 4 pieces. For LI2215-series 6 pieces of each are needed.	Reinforce the wall with at least 32 mm marine plywood, consult producer of partitioning system on the support structure. lag screw DIN 571, 6mm, SS A2, 4 pieces; washer DIN 125 M6, SS A2, 4 pieces. For LI2611-series with 3 flanges 6 pieces of each are needed.
Concealed tank and carriersystem, prepared for armrests.	lag screw DIN 571, 8 mm, SS A2, 7 pieces; washer DIN 125 M8, SS A2, 7 pieces.	lag screw DIN 571, 8mm, SS A2, 4 pieces; washer DIN 125 M8, SS A2, 4 pieces. For LI2215-series 6 pieces of each are needed.	lag screw DIN 571, 6 mm, SS A2, 4 pieces; washer DIN 125 M6, SS A2, 4 pieces. For LI2611-series with 3 flanges 6 pieces of each are needed.

This advice of mounting methods is a recommendation only.

The mounting methods and the length of the screws need to be determined at site according to the type of wall.

Always refer to the manual supplied with the product for detailed instructions per product. These manuals can be downloaded from handicareusa.com. Ensure proper maintenance after deployment of the product. Refer to the maintenance instructions for bathroom modifications. These can also be downloaded from handicareusa.com.

Handicare is not responsible for any inexpert mounting of products and the possible damage as a result of that.

Handicare is not responsible for modified products.

Handicare has compiled this mounting advice with the utmost care.

Commode/shower chairs, shower trolleys



Hassle-free daily care

Copy Here??? Copy Here??? Copy Here??? Copy Here??? Copy Here??? Copy Here???
Copy Here??? Copy Here??? Copy Here??? Copy Here??? Copy Here??? Copy Here???

Commode/shower chairs

Tilting commode/shower chair

- independent swivel armrests, ergonomic shape
- four double braked castors Ø 4.9 in (125 mm)
- backrest HT-cover* material
- adjustable and removable swing away footrests
- hinged soft toilet seat with open front
- removable rails for bedpan Ø 11.8 in (300-315 mm)
- 30° tilting operation by gas spring
- height and depth adjustable headrest
- calf strap and lumbar support
- can be placed over toilet (max. height 17.7 in (450 mm))

* = Hygiene & Transfer: coated woven polyester textile

Article nr.	Description	
LI2150.0214-02	Tilting commode/shower chair, coated ss white	toilet seat open front
LI2135.0212-00	Tilting commode/shower chair, polished ss	toilet seat open front

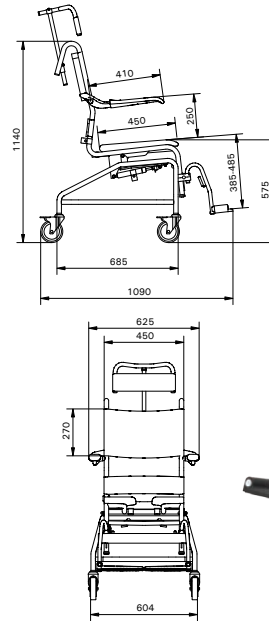

LI2150.0214-02

Height adjustable/tilting commode/shower chair

- independent swivel armrests, ergonomic shape
- four double braked castors Ø 4.9 in (125 mm)
- backrest HT-cover* material
- adjustable and removable swing-away stainless steel footrests
- detachable and reversible soft toilet seat: hygiene opening at front or back at choice, order insert LI09506.636 separately
- removable rails for bucket Ø 11.8 in - 1.4 in (300-315 mm)
- electrical control for adjustment of seat height from 22.8 in - 40.9 in (580 to 1040 mm)
- electrical control for smooth tilt, max. 35°
- safety belt, lumbar support and calf strap included
- height and depth adjustable headrest
- can be placed over toilet
- option 114 not possible as separate order

* = Hygiene & Transfer: coated woven polyester textile

Article nr.	Description	
LI2161.1214-02	Height adjustable/tilting commode/shower chair, coated ss white	hydraulic adjustment
LI2161.1212-00	Height adjustable/tilting commode/shower chair, polished ss	hydraulic adjustment
LI2161.3214-02	Height adjustable/tilting commode/shower chair, coated ss white	electrical adjustment
LI2161.3212-00	Height adjustable/tilting commode/shower chair, polished ss	electrical adjustment

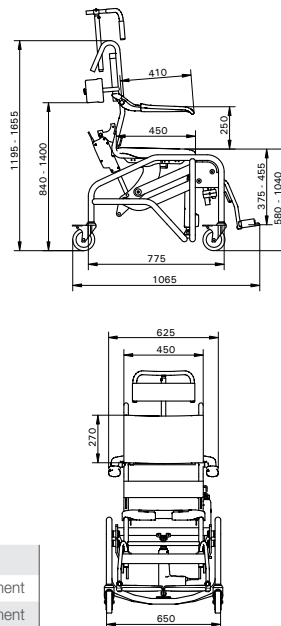

LI2161.3214-02

Commode/shower chairs

Mobile commode/shower chair

- independent swivel armrests, ergonomic shape
- backrest HT-cover* material
- hinged soft toilet seat with open or closed front
- rails for bedpan and bucket Ø 11.8 in - 12.4 in (300-315 mm)
- four double braked castors Ø 4.9 in (125 mm)
- adjustable swing-up footrests
- seat height LI2137.0111/021 is 24 in (610 mm)
- seat height LI2137.1111/121 is 20.9 (530 mm)

* = Hygiene & Transfer: coated woven polyester textile

	A	B	C	D
LI2137.021	570	495	550	320-480
LI2137.121	490	415	470	320-400

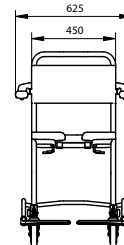
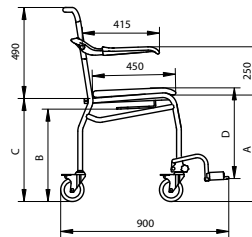

LI2137.0211-02

Article nr.	Description	
LI2137.0111-02	Coated steel white	toilet seat with closed front
LI2137.0211-02	Coated steel white	toilet seat with open front
LI2137.0114-02	Coated ss white	toilet seat with closed front
LI2137.0214-02	Coated ss white	toilet seat with open front
LI2137.0112-00	Polished ss	toilet seat with closed front
LI2137.0212-00	Polished ss	toilet seat with open front
seat height 610 mm		
LI2137.1111-02	Coated steel white	toilet seat with closed front
LI2137.1211-02	Coated steel white	toilet seat with open front
LI2137.1114-02	Coated ss white	toilet seat with closed front
LI2137.1214-02	Coated ss white	toilet seat with open front
LI2137.1112-00	Polished ss	toilet seat with closed front
LI2137.1212-00	Polished ss	toilet seat with open front
seat height 530 mm		

Commode/shower chair (self propelling)

- independent swivel armrests, ergonomic shape
- backrest HT-cover* material
- hinged soft toilet seat with open or closed front
- distance from wall – centre toilet opening: 21.5 in (545 mm)
- rails for bedpan and bucket Ø 11.8 in - 12.4 in (300-315 mm)
- double braked castors Ø 4.9 in (125 mm) and moulded 24 in wheels with brake and rim
- adjustable swing-up footrests
- seat height LI2138.0111/021 is 24 in (610 mm)
- seat height LI2138.1111/121 is 20.9 in (530 mm)

* = Hygiene & Transfer: coated woven polyester textile

	A	B	C	D
LI2138.021	570	495	550	320-480
LI2138.121	490	415	470	320-400

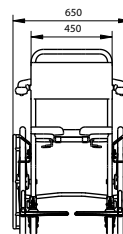
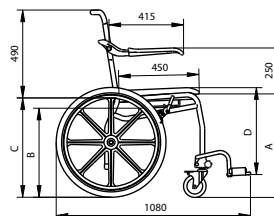

LI2138.1211-02

Article nr.	Description	
LI2138.0111-02	Coated steel white	toilet seat with closed front
LI2138.0211-02	Coated steel white	toilet seat with open front
LI2138.0114-02	Coated ss white	toilet seat with closed front
LI2138.0214-02	Coated ss white	toilet seat with open front
LI2138.0112-00	Polished ss	toilet seat with closed front
LI2138.0212-00	Polished ss	toilet seat with open front
seat height 610 mm		
LI2138.1111-02	Coated steel white	toilet seat with closed front
LI2138.1211-02	Coated steel white	toilet seat with open front
LI2138.1114-02	Coated ss white	toilet seat with closed front
LI2138.1214-02	Coated ss white	toilet seat with open front
LI2138.1112-00	Polished ss	toilet seat with closed front
LI2138.1212-00	Polished ss	toilet seat with open front
seat height 530 mm		

Shower trolleys

Height adjustable shower trolley

- HT-cover* material
- four double braked castors Ø 4.9 in (125 mm)
- pvc water receiver with flexible hose of 39.4 in (1000 mm)
- height adjustable via hydraulic pump
- two hinged side fences
- only available in the dimensions as mentioned

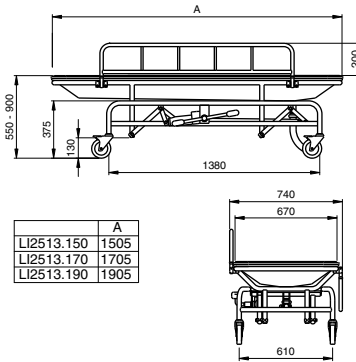

* = Hygiene & Transfer: coated woven polyester textile

Article nr.	Description	length 74.8 in
LI2513.1904-02	Height adjustable shower trolley, coated ss white	

Height adjustable shower trolley

- HT-cover* material
- four double braked castors Ø 14.9 in (125 mm)
- adjustable backrest by means of a gas spring
- pvc water receiver with flexible hose of 39.4 in (1000 mm)
- height adjustable via hydraulic pump
- two hinged side fences
- only available in the dimensions as mentioned

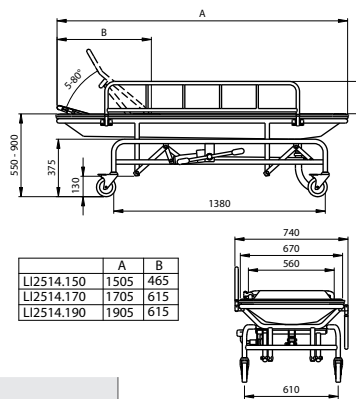

* = Hygiene & Transfer: coated woven polyester textile

Article nr.	Description	length 74.8 in
LI2514.1904-02	Height adjustable shower trolley, coated ss white	

Hinged side fence

- suitable for all Linido shower stretchers and shower trolleys
- including plastic mounting clamps

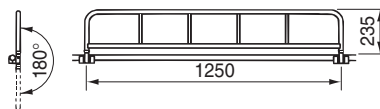

Article nr.	Description	length 149.2 in
LI2590.1254-02	Hinged side fence, coated ss white	

Combi commode/shower chairs, mobile

Combi shower chair, attendant operated

- stainless steel frame for wet environments and durability
- height adjustable frame
- independent swivel armrests made from soft polyurethane
- detachable seat and backrest, seat with keyhole shaped opening
- 4 maintenance free castors Ø 3.9 in (100 mm) with double brake
- max. user weight 330 lbs (150 kg)
- max. user weight Heavy Duty 440 lbs (200 kg)
- footrests and other accessories can be ordered separately



201903314

Article nr.	Description
201904314	Combi shower chair, attendant operated, seat height (including toilet seat) 19.9 in - 24.8 in (505-630 mm)
201903314	Combi shower chair, attendant operated, seat height (including toilet seat) 17.9 in - 21.5 in (455-545 mm)
201911314	Combi shower chair, attendant operated, Heavy Duty, seat height (including toilet seat) 19.9 in - 24.8 in extra wide

Combi shower chair, self-propelled

- stainless steel frame for wet environments and durability
- height adjustable frame (via snaplock clips) allows adjustment for different user heights as well as placement of the chair over different toilets heights
- independent swivel armrests made from soft polyurethane
- detachable seat and backrest, seat with keyhole shaped opening
- 2 maintenance free castors Ø 3.9 in (100 mm) with double brake and 2 self-propelling wheels 24 in with hoop
- max. user weight 330 lbs (150 kg)
- footrests and other accessories can be ordered separately



201921314

Article nr.	Description
201921314	Combi shower chair, self-propelled, standard
201930314	Combi shower chair, self-propelled, extra wide

Combi tilt commode/shower chair, attendant operated

- Combi tilt, manual operation: gas spring adjustable by a handle
- Combi powered, electrical operation with remote control
- stainless steel frame for wet environments and durability
- height adjustable frame
- independent swivel armrests made from soft polyurethane
- detachable seat and backrest, seat with keyhole shaped opening
- 4 maintenance free castors Ø 4.9 in (125 mm) with double brake
- max. user weight 330 lbs (150 kg)
- footrests and other accessories can be ordered separately



201942314

Article nr.	Description
201941314	Combi tilt commode/shower chair, attendant operated, manual tilt
201942314	Combi tilt commode/shower chair, attendant operated, electrical powered tilt

Combi commode/shower chairs, STET

Accessories for Combi commode/shower chairs

Article nr.	Description	
201060004	Amputee support	left or right, for all Combi chair models and variants
201030310	Armrest lock	1 pair, for all Combi chair models and variants
853100033	Bucket with lid	round, grey plastic, for all variants of Combi chairs attendant operated and Combi, self-propelled
853100034	Bucket with lid	keyhole shaped, white plastic, for all Combi chair models and variants
200810004	Footrests	1 pair, for all Combi chair models and variants
201040314	Front cross bar	for all Combi chair models and variants with standard width Recommended for use with the Armrest lock accessory
200360004	Headrest	padded polyurethane, for all Combi chair models and variants
200384004	Heel and calf strap	for all Combi chair models and variants
200382004	Hip belt	for all Combi chair models and variants
201070314	Lateral trunk support, right	for all Combi chair models and variants
201072314	Lateral trunk support, left	for all Combi chair models and variants
201061004	Leg support	for Amputee support 201060004, with all Combi chair models and variants
201130314	Soft backrest standard	textile with Velcro, for Combi, attendant operated with standard height and width
201131314	Soft backrest tilt chairs	textile with Velcro, for Combi, tilt with manual or powered tilt
853100604	Transport seat cover	for all Combi chair models and variants



201060004



853100033



853100034



201030310



200810004



201040314



200360004



200384004



201070314



201130314



200382004



201061004



853100604

Technical Information

Maintenance

Products used in the bathroom or shower: rinse after use with clean water.
For all products: clean with mild, non abrasive cleaners only. Rinse with clean water after use.

Guarantee

Two years warranty on all products, excluding the cushioned cover for shower seat (LI09506.400) and Neoprene parts, which is one year.
Linido bathroom solutions conform to the highest standards and comply to the requirements of NEN-EN12182 and to the directive medical devices 93/42/EEG.
We are ISO 9001, ISO 13485 and NKH certified.



Material specifications

- steel ST37.2, DIN 17100, Ø 1.125 in x 0.5 in
- steel ST37.2, DIN 17100, Ø 1.1 in x 0.5 in
- stainless steel AISI 304, Ø 1 in x 0.5 in
- stainless steel AISI 316, Ø 1 in x 0.5 in
- plastic shower seats: glassfibre reinforced nylon
- wall flanges Ergogrip and wall plate hinged arm support: glassfibre reinforced nylon
- plastic bathroom accessories: PMMA
- HT-cover = Hygiene & Transfer, material: special coated woven polyester textile
- wall plates of shower seats: stainless steel AISI 304

Moving and/or hinged parts are always made of stainless steel and/or plastic.

Preparation for coating

Before coating, steel is alkaline de-greased, phosphated and passified.

Coating

Epoxy polyester, 80-100 µm thick. Weather-resistant and hardened (International Buchholz hardness test to DIN 53153: > 80).
Meets salt spray test to DIN 50021/ASTM B117 (1000 hours, < 1mm).

Isolation sets

Because of the necessary electrical isolation, products for wall mounting or floor mounting, which are not designed with plastic flanges or wall plates, will be delivered with an isolation set including heavy duty washers and caps.

Maintenance, washing and cleaning instructions

Maintenance before and during use

Handicare advises to inspect the product regularly on the following points:

- Make sure that the product is properly installed and/or assembled.
- Make sure all screws and bolts are tightened properly.
- Make sure clips are in the right position and can safely perform their duties.
- Regularly check that all the components are in place and properly tightened.
- Check for possible damage.

Daily cleaning

1. For optimal hygiene it is recommended to rinse the product immediately after use with hot water or a mild soap solution (PH 6-8).
We recommend not to use chlorine, solvents, abrasive or aggressive cleaning agents, as this can cause discoloration of the coating, PUR- and plastic parts, or even may cause damage the material itself. Some parts, such as a seat or bedpan can be removed or folded to facilitate easy cleaning. It is important that these parts are put back correctly.
2. After rinsing, the product should be wiped with a clean, damp, soft cloth. The rinse and wipe ensures that soap and secretions are removed immediately and so avoid the risk of bacteria growth.
3. Allow the product to dry, preferably in a well ventilated area, before it is used again.

Mounting materials

Linido products will be delivered without any mounting materials, except for bathroom accessories. Determine the type of wall and use suitable fixings. For a durable, reliable mounting, use only corrosion resistant fixing materials.

Weight limits for normal use

Shower seats

user weight: max. 330 lbs (150 kg).
user weight for ergonomic shower seat and shower seat combination with a Floor support set:
max. 660 lbs (300 kg).
load per armrest: max. 165 lbs (75 kg).

Hinged arm supports

user weight: max. 330 lbs (150 kg).
lateral pressure: max. 220 lbs (100 kg).

Grab rails Ergogrip

user weight: max. 330 lbs (150 kg).

Commode/shower chairs

user weight: max. 440 lbs (200 kg).
load per armrest: max. 220 lbs (100 kg).

Tilting commode/shower chair and height adjustable-/tilting shower chairs

user weight: max. 330 lbs (150 kg).
load per armrest: max. 220 lbs (100 kg).

Combi commode/shower chairs

user weight: max. 330 lbs (150 kg).
load per armrest: max. 165 lbs (75 kg).

Tolerances for all indicated dimensions are ± 0.25 in.

Handicare reserves the right to modify designs as part of our ongoing product development.

**Making
everyday life
easier**



10888 Metro Court
St. Louis, MO 63043
866.891.6502
www.handicareusa.com